

4

3

2

1

ITEM NO.	PART NUMBER	DESCRIPTION	QTY.
1	KT-000-11-0000	CHASSIS ASSEMBLY	1
2	KT-000-03-0000	MODULAR TABLE SYSTEM	1
3	KT-000-03-0010	ADAPTER PLATE KIT	1

KINETIC TECHNOLOGIES RT1 SYSTEM SPECIFICATIONS:

- 2,450 NM START/STOP TORQUE
- 1,960 MAXIMUM RATED TORQUE
- 9,800 NM MAXIMUM MOMENTARY TORQUE
- 1 ARC MIN BACKLASH (1/60TH OR .0166 DEGREES)
- 8,820 NM MAXIMUM MOMENT LOADING
- CABLE PROTECTION (ALL CABLES CAN BE ROUTED INSIDE CABINET TO PROTECT FROM SPATTER AND UV DEGRADATION)
- RIGID, REPEATABLE POSITIONING
- MODULAR SYSTEM TO ADD/REMOVE COMPONENTS
- CUSTOM CONFIGURATION AND EXPANSION AVAILABLE
- SMALL CELL FOOTPRINT
- STANDARD PACKAGE EQUIPPED WITH 200V 3 PHASE 750W YASKAWA SERVO MOTOR. (SGM7G-09A7DK1)

FOR CUSTOM MOTOR APPLICATIONS:

- STANDARD GEARBOX ACCEPTS MOTOR SHAFT SIZES 19-28mm
- MOTOR SHAFT BUSHINGS AVAILABLE (MUST BE SPECIFIED)
- MOTOR MOUNT FLANGES AVAILABLE (MUST BE SPECIFIED)

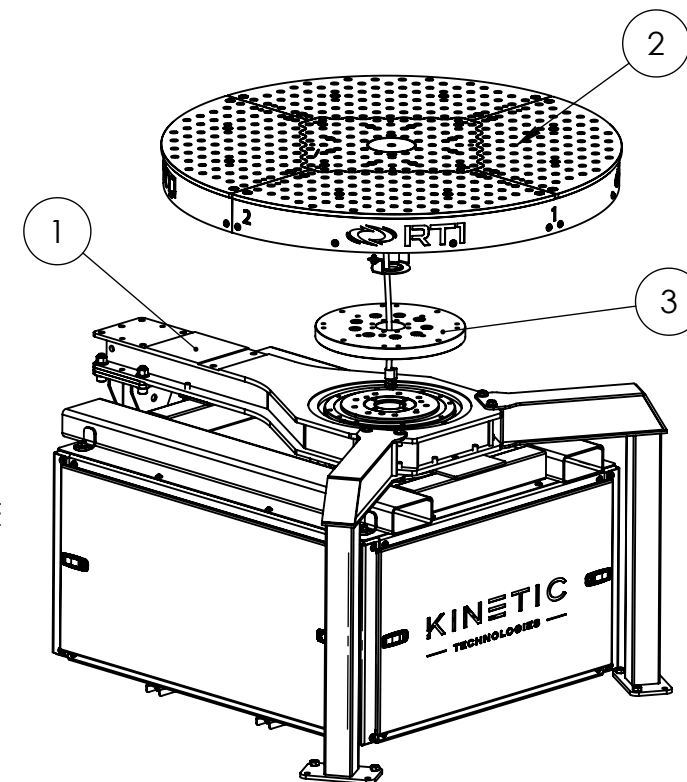
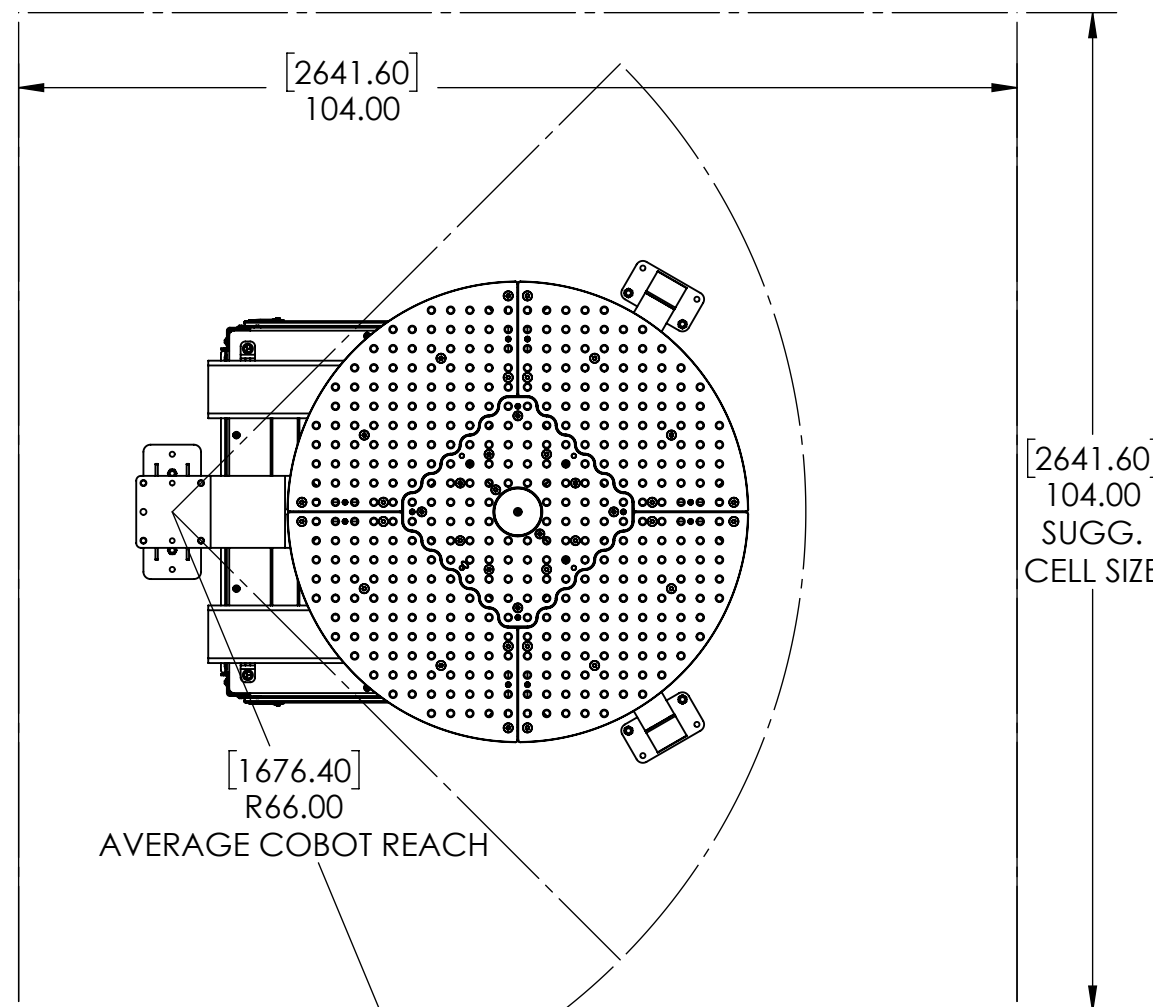

[2641.60]
104.00
SUGG.
CELL SIZE

[1676.40]
R66.00
AVERAGE COBOT REACH

[1219.12]
48.00
MODULAR TABLE SYSTEM

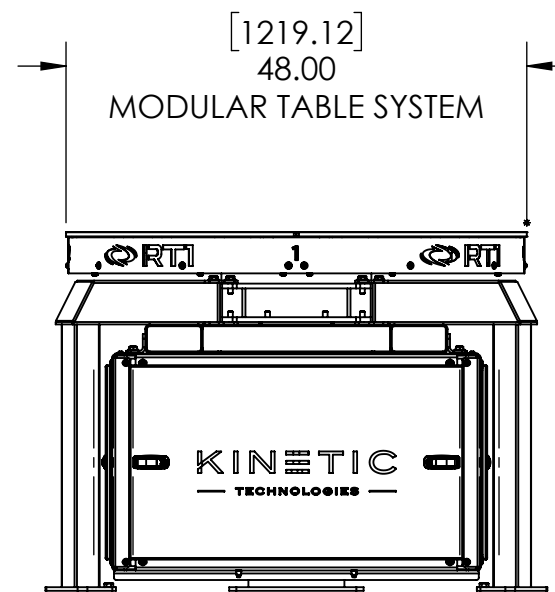
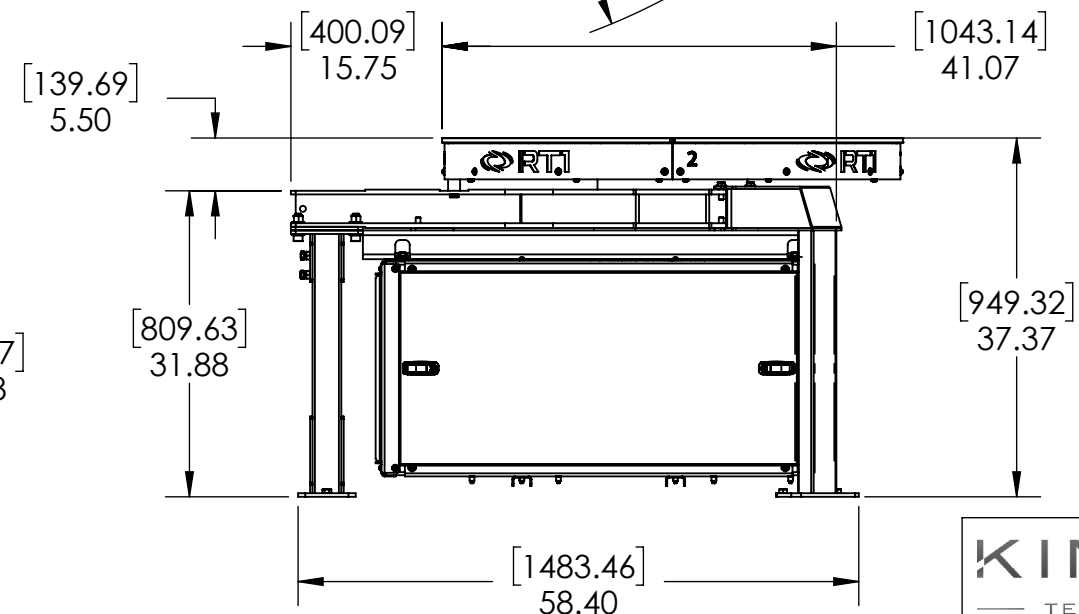
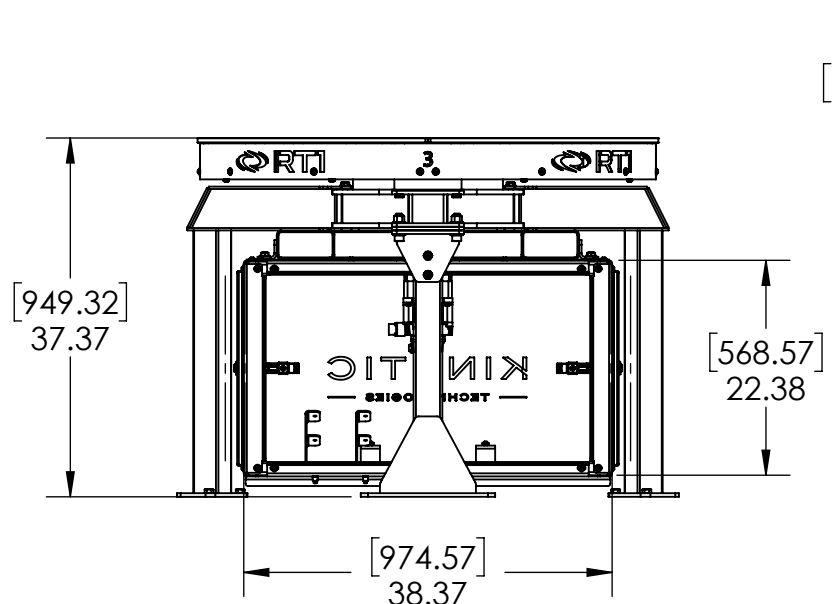

KINETIC
— TECHNOLOGIES —

DESCRIPTION

THIRD ANGLE
DRAWN
DATE
08/28/2023

MATERIAL

FINISH

WEIGHT

UNLESS OTHERWISE SPECIFIED:
DIMENSIONS ARE IN INCHES
DIMENSIONS PER ASME Y14.5-2018
TOLERANCES:
FRACTIONAL ± .0625
ANGULAR: BEND ± .5 DEG
TWO PLACE DECIMAL ± .01
THREE PLACE DECIMAL ± .005

SIZE DWG. NO. REV
B KT-000-00-0000-COMPONENTS A

SCALE: 1:20 DO NOT SCALE DRAWING SHEET 1 OF 1

4

3

2

1

B

B

A

A